

DANA-FARBER Longwood Campus

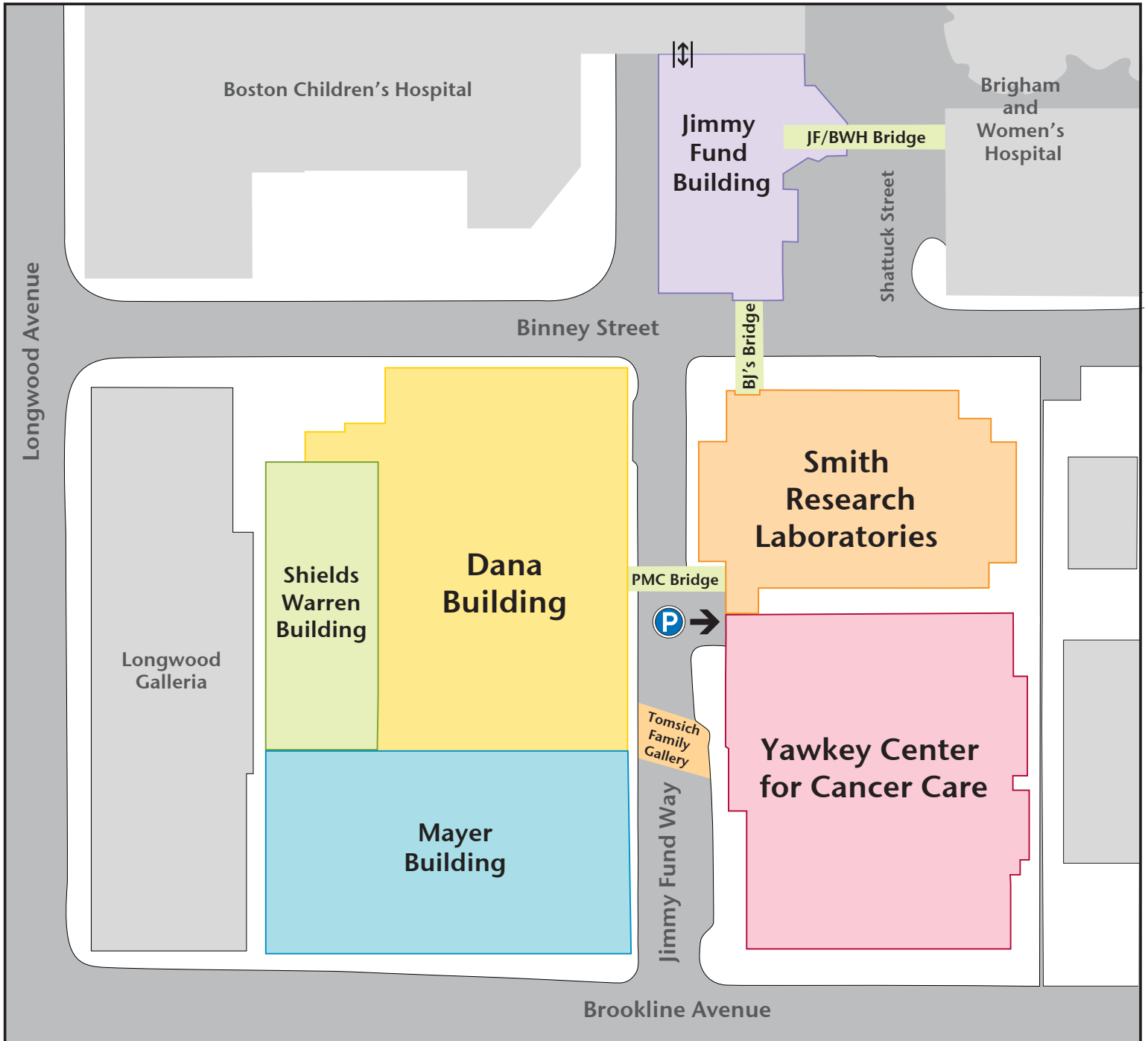

YAWKEY Floor P1

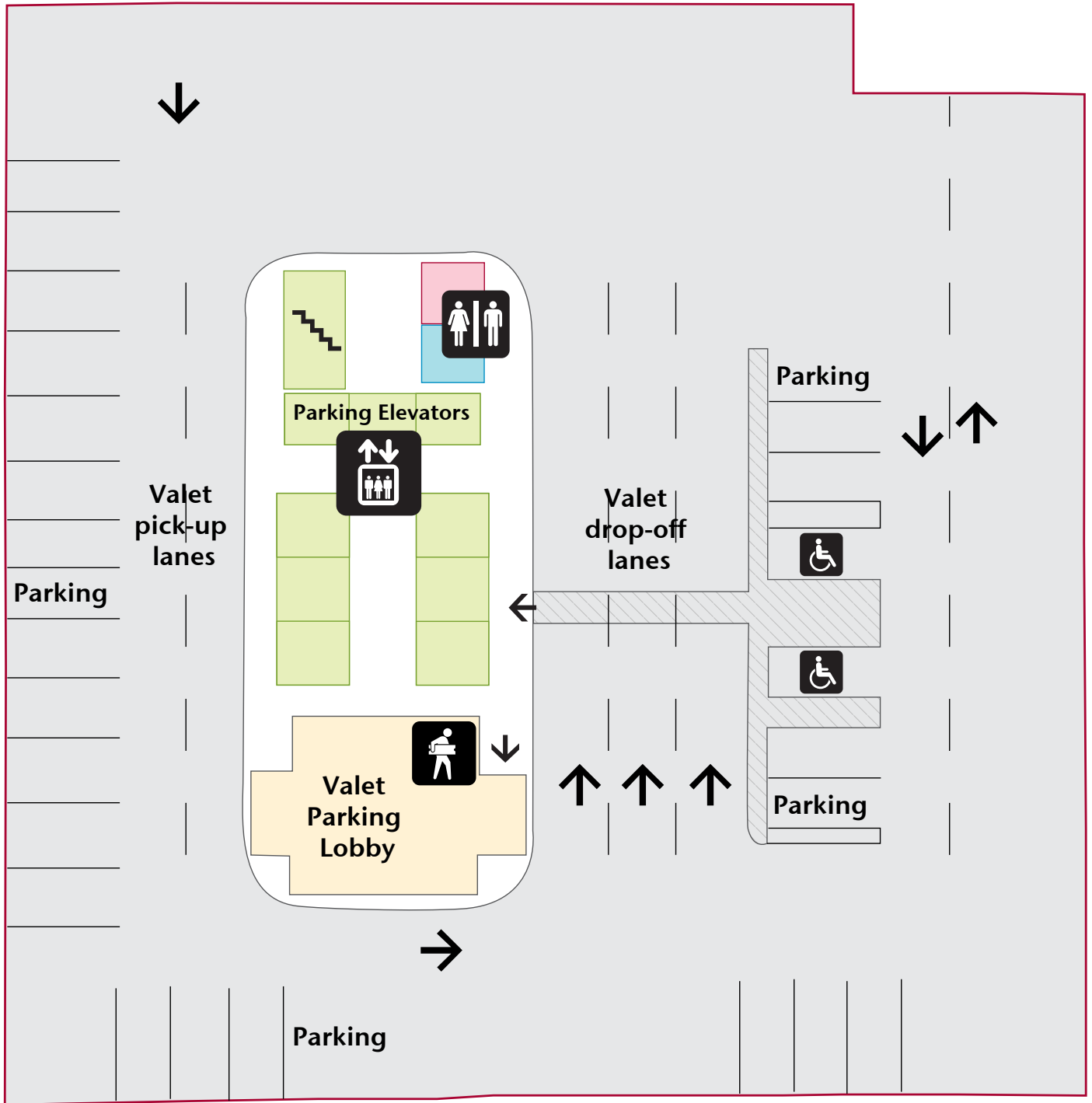

Parking Pay Station

YAWKEY Floor 1

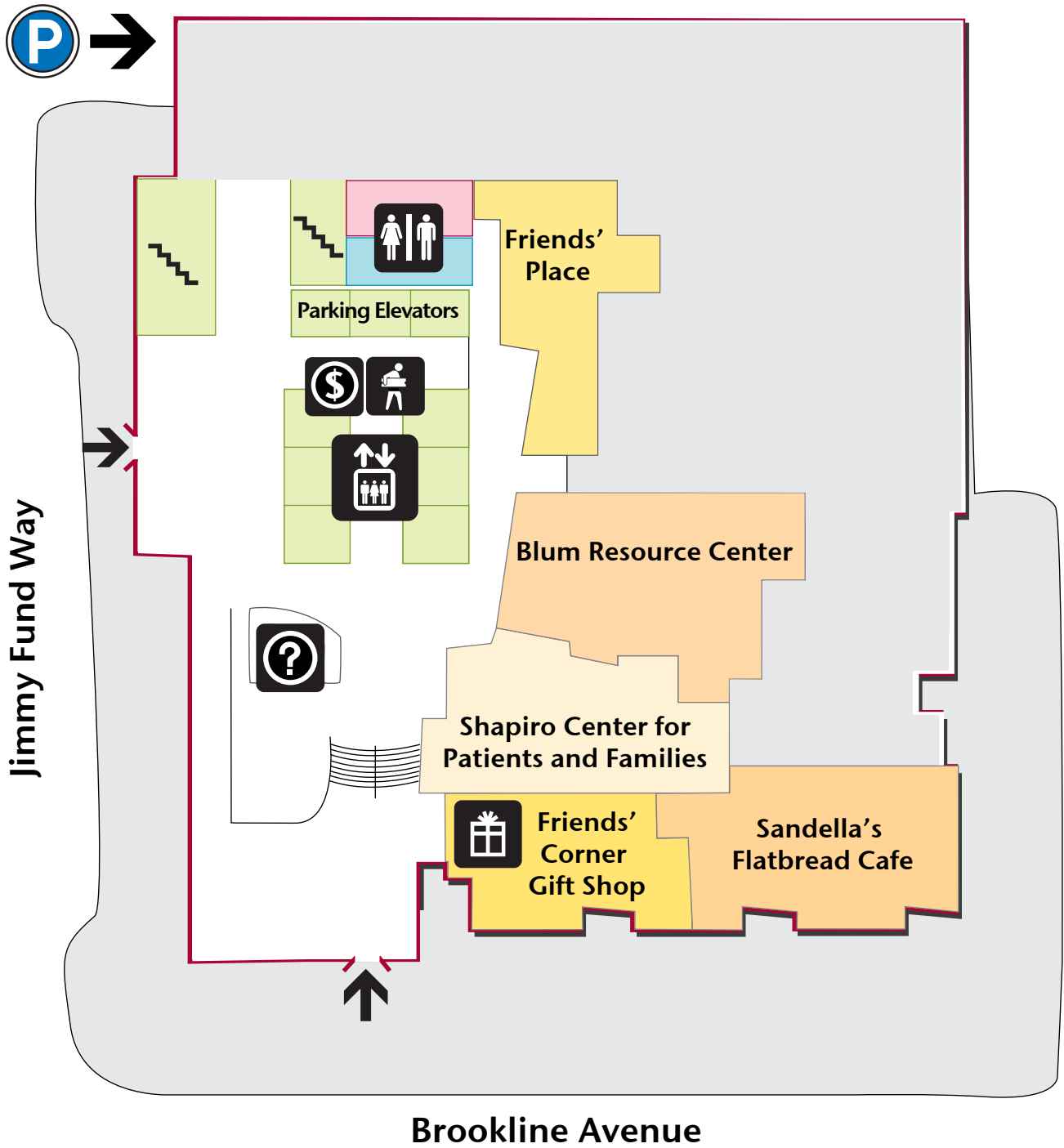

YAWKEY Floor 2

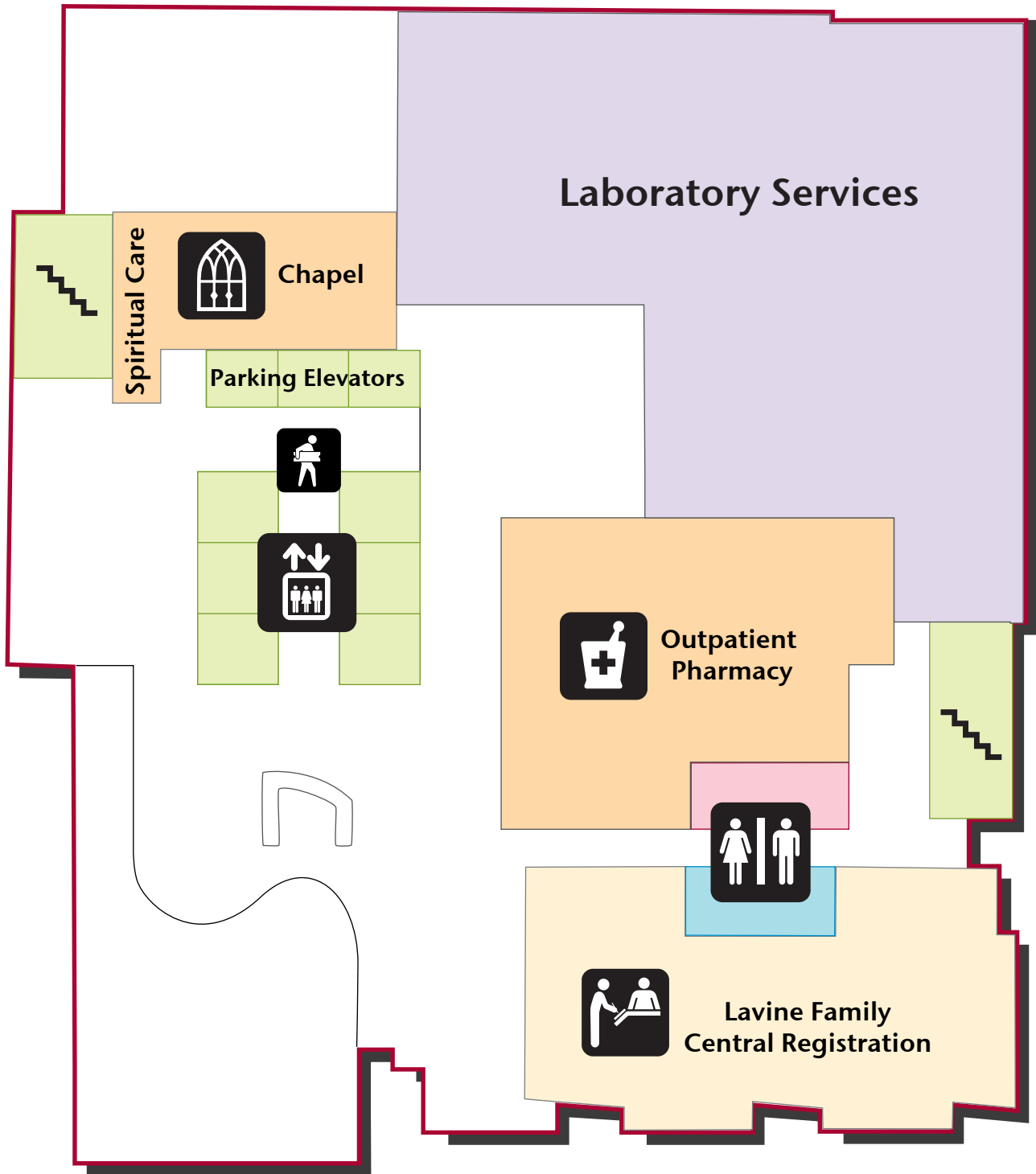

YAWKEY Floor 3

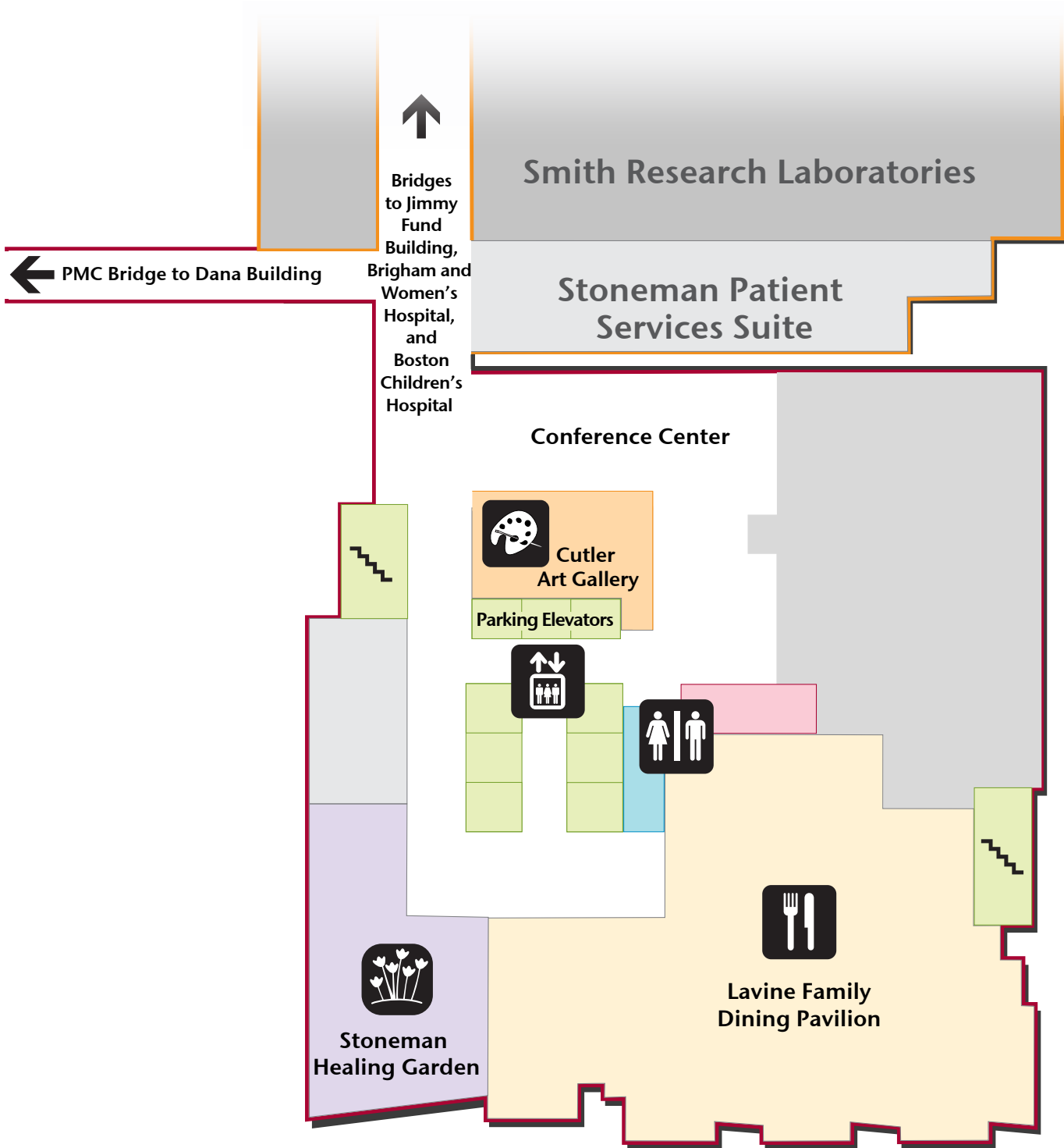

YAWKEY Standard Clinical Floor Floors 5-11

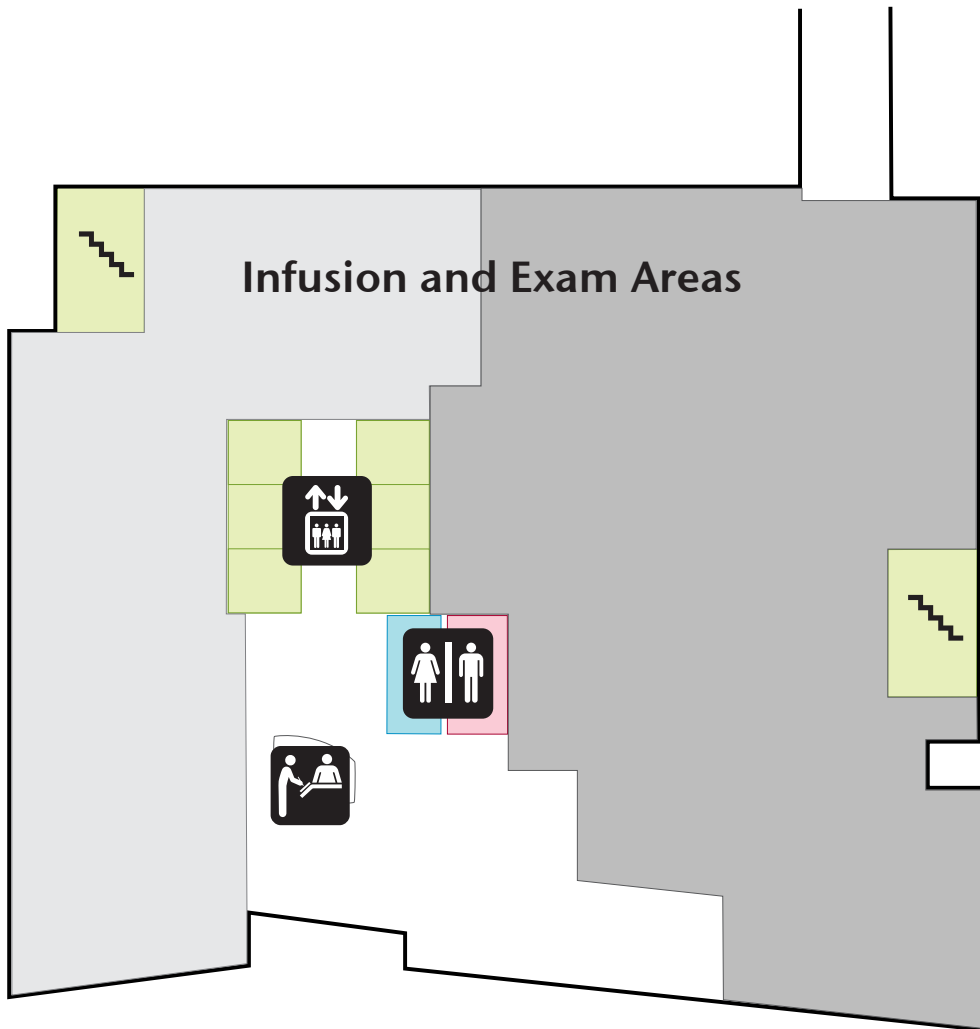

Dana-Farber Cancer Institute, Longwood Campus

All locations are in the Yawkey Center, unless otherwise noted.

Cutler Art Gallery	3	Zakim Center for Integrative Therapies	6
Jimmy Fund Auditorium	Jimmy Fund G	Jimmy Fund Clinic	Dana 3
Kraft Family Blood Donor Center	Jimmy Fund 1	Laboratory Services	2
Breast Oncology	9	Leukemia	8
Bridges to affiliated hospitals	3	Bekenstein Family Atrium Lobby	1
Brigham and Women's Hospital		Lubin Lobby	2
Boston Children's Hospital		Lymphoma	8
Brigham and Women's Hospital	via 3rd floor bridge	Melanoma	11
Cancer Genetics and Prevention	9	Lipper Center for Multiple Myeloma	7
Chapel	2	Neuro-Oncology	10
Boston Children's Hospital	via 3rd floor bridge	Nuclear Medicine	Dana L2
Clinical Research Center	6	Adult Palliative Care	11
Concierge Services (<i>Shapiro</i> Center)	1	Parking Elevators	P2, P1, 1, 2, 3
Conference Center	3	Parking Valet/Cashier	P1
Cutaneous Oncology	11	Patient and Family Drop-off/Pick-up	P1
Dana Building and		Blum Patient and Family Resource Center	1
Tomsich Family Gallery to:	P2	Blum Pediatric Resource Room	Dana 3
Lank Imaging		Outpatient Pharmacy	2
Nuclear Medicine		Radiation Oncology	Dana L2
Radiation Oncology		Registration	
PMC Bridge to:	3	Lavine Family Central Registration	2
Jimmy Fund Clinic		Imaging and Radiation Oncology Registration	Dana L2
Stop & Shop Family Pediatric Brain Tumor Clinic		Pediatric Registration	Dana 3
Pediatric Psychosocial Oncology		Sarcoma and Bone Oncology	6
Desensitization Unit	11	Shapiro Center for Patients and Families	1
Lavine Family Dining Pavilion	3	Spiritual Care (Chaplains)	2
Early Drug Development	6	Stem Cell Transplantation	8
Friends' Corner Gift Shop	1	Lowe Center for Thoracic Oncology	10
Friends' Place	1	Susan F. Smith Center for Women's Cancers	9, 10
Gastrointestinal Oncology	7	Breast Oncology	9
Lank Center for Genitourinary Oncology	11	Gynecologic Oncology	10
Gynecologic Oncology	10		
Head and Neck Oncology	11		
Stoneman Healing Garden	3		
Hematologic Malignancies	7, 8		
Hematology	8		
Lank Imaging	Dana L1		
Information	1		

Patient & Family Resources

Locations listed here are in the Yawkey Center, unless otherwise noted.

<i>Cutler</i> Art Gallery	3
Chapel	2
Concierge Services (<i>Shapiro</i> Center)	1
<i>Lavine</i> Family Dining Pavilion	3
Financial Counseling	2
<i>Friends'</i> Corner Gift Shop	1
<i>Friends'</i> Place	1
<i>Stoneman</i> Healing Garden	3
Jazzman's Cafe and Bakery	Dana 1
Outpatient Pharmacy	2
<i>Blum</i> Patient and Family Resource Center	1
<i>Shapiro</i> Center for Patients and Families	1
<i>Blum</i> Pediatric Resource Room	Dana 3
Sandella's Flatbread Cafe	1
Spiritual Care (Chaplains)	2